

13th STREET

WEST ARCH STREET

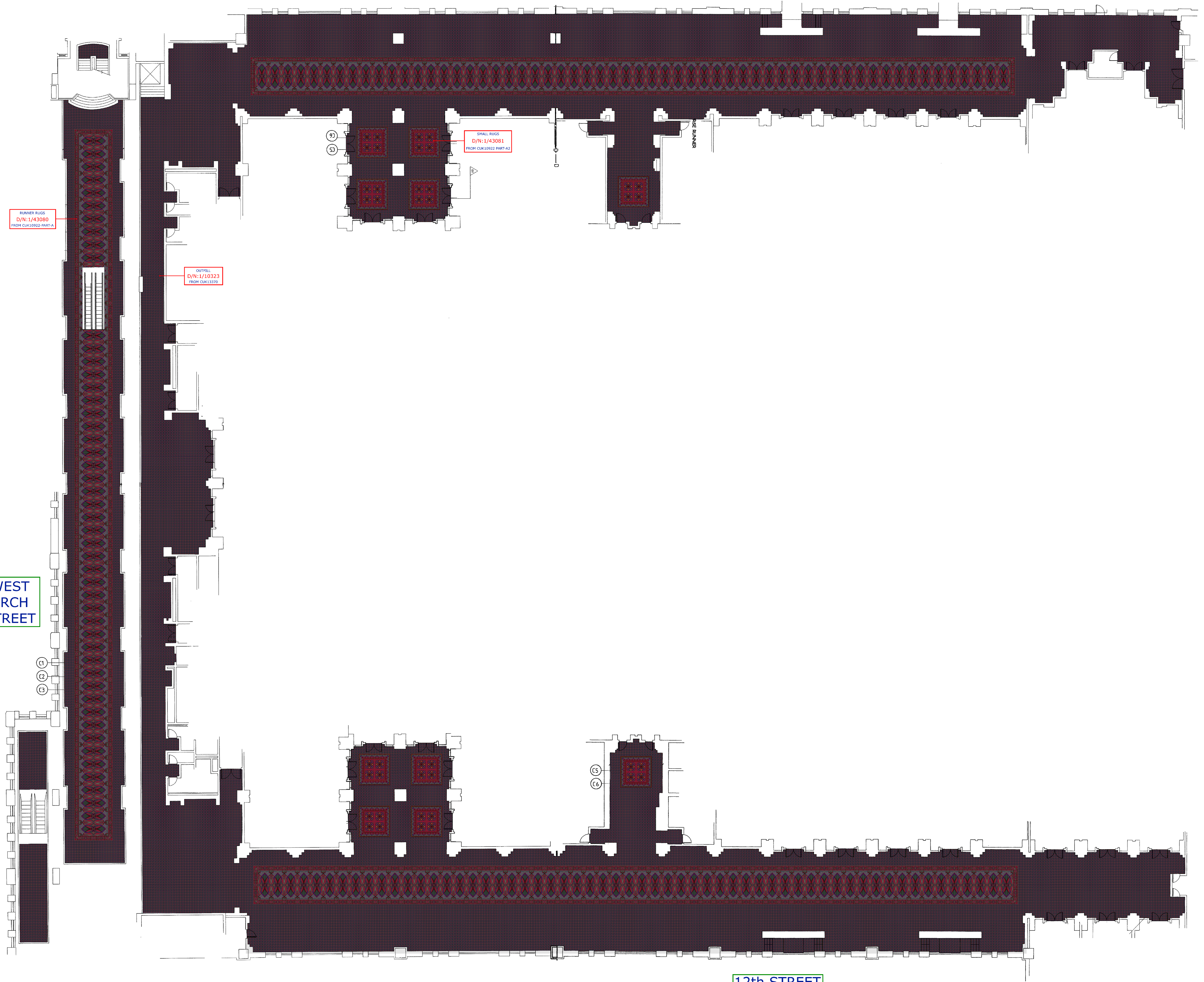

12th STREET

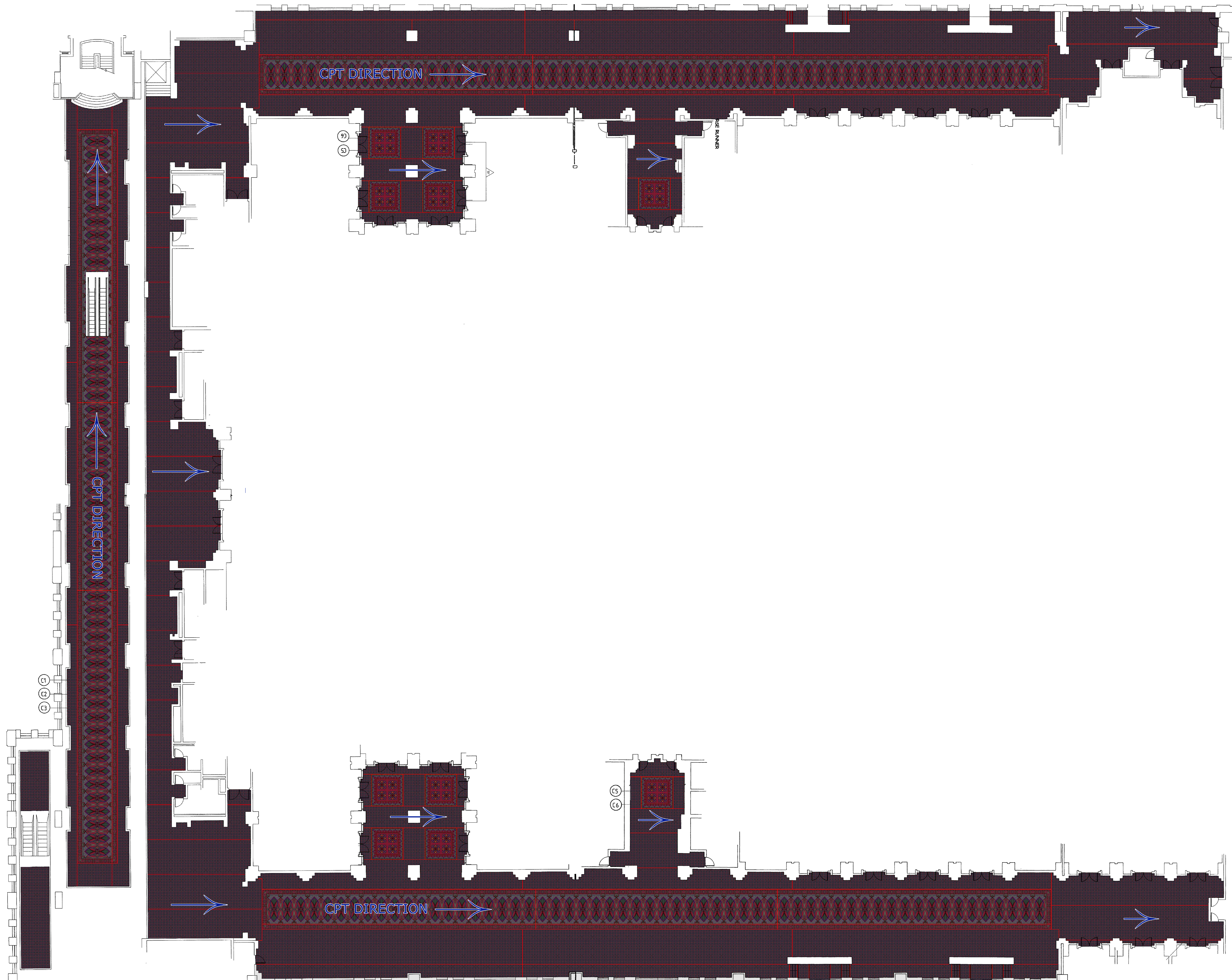

13th STREET



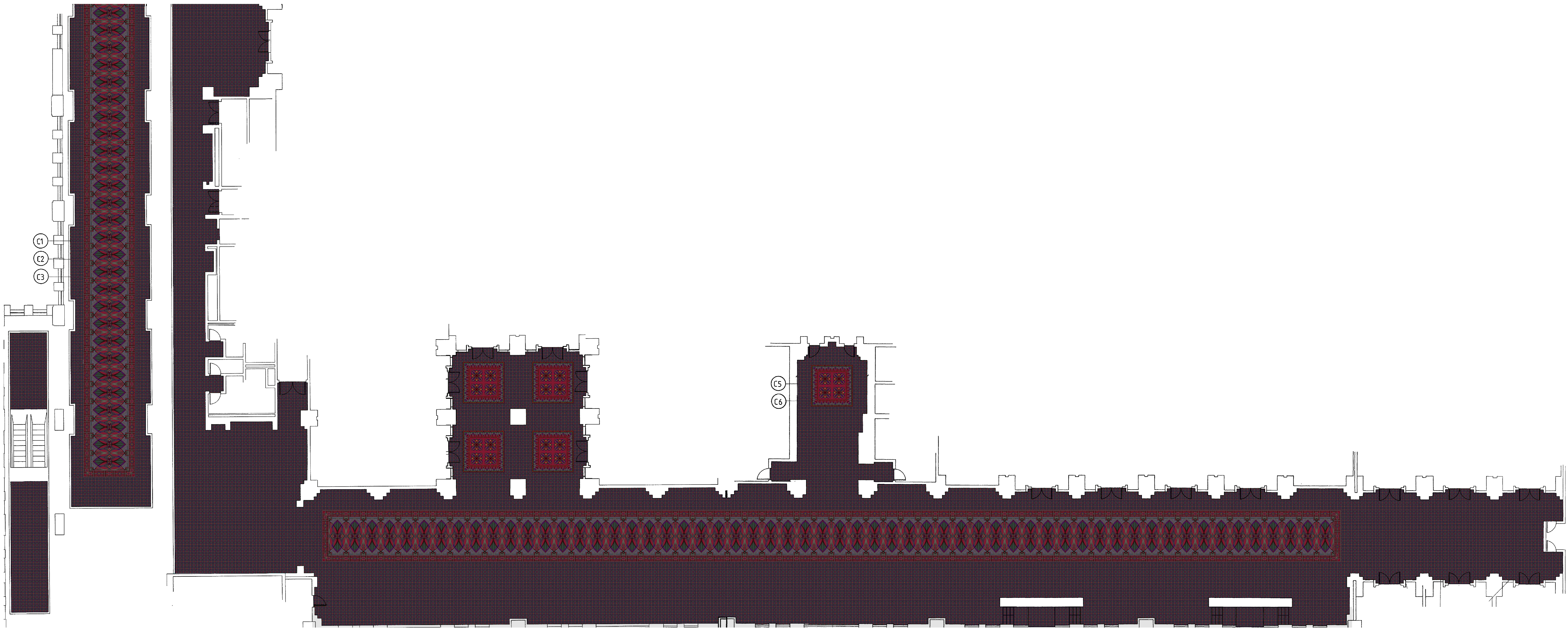

D/N: 1/43080 - CONCOURSE RUGS FROM PREVIOUS CUK10922



Design Size: 15ft 0in x 100ft 0in
Print Scale: 1:50.00



Design Size: 15ft 0in x 103ft 0in
Print Scale: 1:50.00



Design Size: 15ft 0in x 100ft 0in
Print Scale: 1:50.00



Design Size: 15ft 0in x 95ft 0in
Print Scale: 1:50.00



Design Size: 15ft 0in x 93ft 0in
Print Scale: 1:50.00



Design Size: 15ft 0in x 95ft 0in
Print Scale: 1:50.00



Design Size: 15ft 0in x 100ft 0in
Print Scale: 1:50.00



Design Size: 15ft 0in x 103ft 0in
Print Scale: 1:50.00



Design Size: 15ft 0in x 100ft 0in
Print Scale: 1:50.00

- C5014 RED 1
- C4541 BROWN 2
- 10 GREY 3
- C5160 PURPLE 4
- C5167 DK TAUPE 5
- C5151 OLIVE GREEN 6
- C5162 LT. COOL GREY 7
- C5148 YELLOW 8

D/N: 1/43081 - SMALL RUG FROM CUK10922

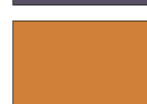

Design Size: 12ft 0in x 12ft 0in
Print Scale: 1:10 (1 1/5" to 1 Foot)

- C5151 OLIVE GREEN 1 
- C4541 BROWN 2 
- 10 GREY 3 
- C5160 PURPLE 4 
- C5167 DK TAUPE 5 
- C5014 RED 6 
- C5162 LT. COOL GREY 7 
- C5148 YELLOW 8 









D/N: 1/10323 - OUTFILL FROM CUK13370



Design Size: 1ft 0in x 1ft 0in
Print Scale: 1:10 (1 1/5" to 1 Foot)



Design Size: 1ft 0in x 1ft 0in
Print Scale: 1:2 (Half Scale)

- C5014 RED 1 
- C4541 BROWN 2 
- 10 GREY 3 
- C5167 DK TAUPE 4 
- C5151 OLIVE GREEN 5 
- C5160 PURPLE 6 
- C5162 LT. COOL GREY 7 
- C5148 YELLOW 8 

12th STREET / 13th STREET / WEST ARCH STREET



THE SEAMING LAYOUT IS BASED ON PLANS SUBMITTED BY THE INTERIOR DESIGNER/CLIENT. DUE TO MANUFACTURING TOLERANCES AND ON-SITE CONDITIONS THE SEAM LINES AND DIMENSIONS SHOWN ARE FOR GUIDANCE ONLY, ADDITIONAL SEAMS MAY BE REQUIRED.

- PLAN KEY**
- =.....KNOWN SEAM LINES
 - △ =.....ROLL # AND ROLL DIRECTION
 - =.....ROLL LENGTH

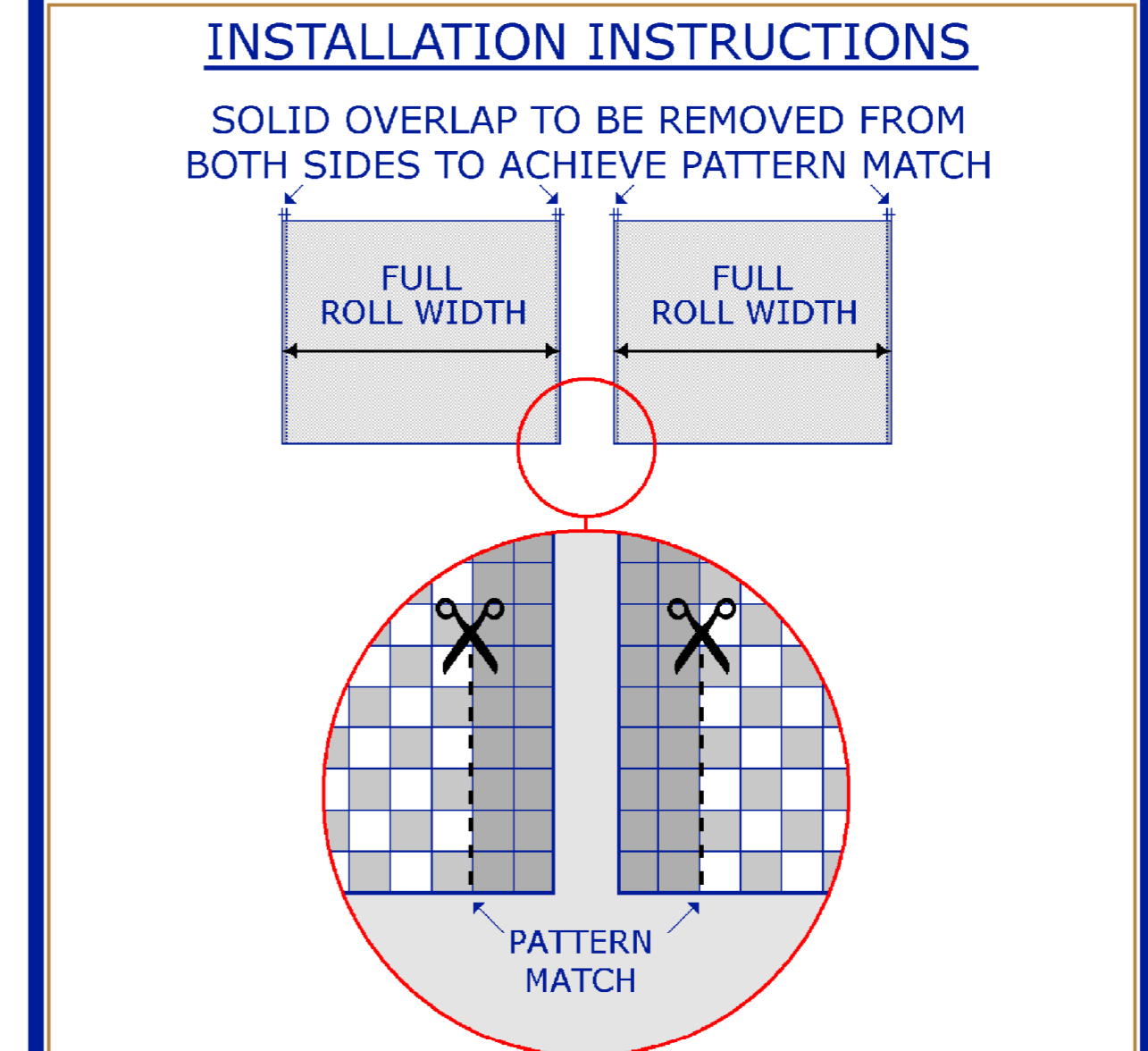

REVISIONS

1. CONCOURSE STEPS COLORATION UPDATED TO C3 CARPET. 27. MARCH. 2020

PROJECT REFERENCE	
PCCA	
12th STREET / 13th STREET / WEST ARCH STREET	
YARDAGE BASED ON : 13.142' AXMINSTER	
12th / 13th / WEST ARCH STREET	
CONCOURSE RUNNER RUGS	= 1755.19sy
OUTFILL	= 4964.76sy
TOTAL	= 6719.94sy
ATTIC	= 680.46sy
PROJECT TOTAL	= 7400.41sy
[TAKE OFF: CB1062 - ORIGINAL - 24.MAR.2020]	
APPROVED FOR LAYOUT BY:	DATE:
<i>Shayma Shagoo</i>	
	(CLIENT)
APPROVED FOR YARDAGE BY:	DATE:
	(INSTALLER)
SCALE : 3/32" = 1'	DATE : 27.MAR.2020
DRAWN BY : JM/MC	ORDER #:
DRAWING #:	REVISION #:
CB1062-P1	1
1 OF 2	

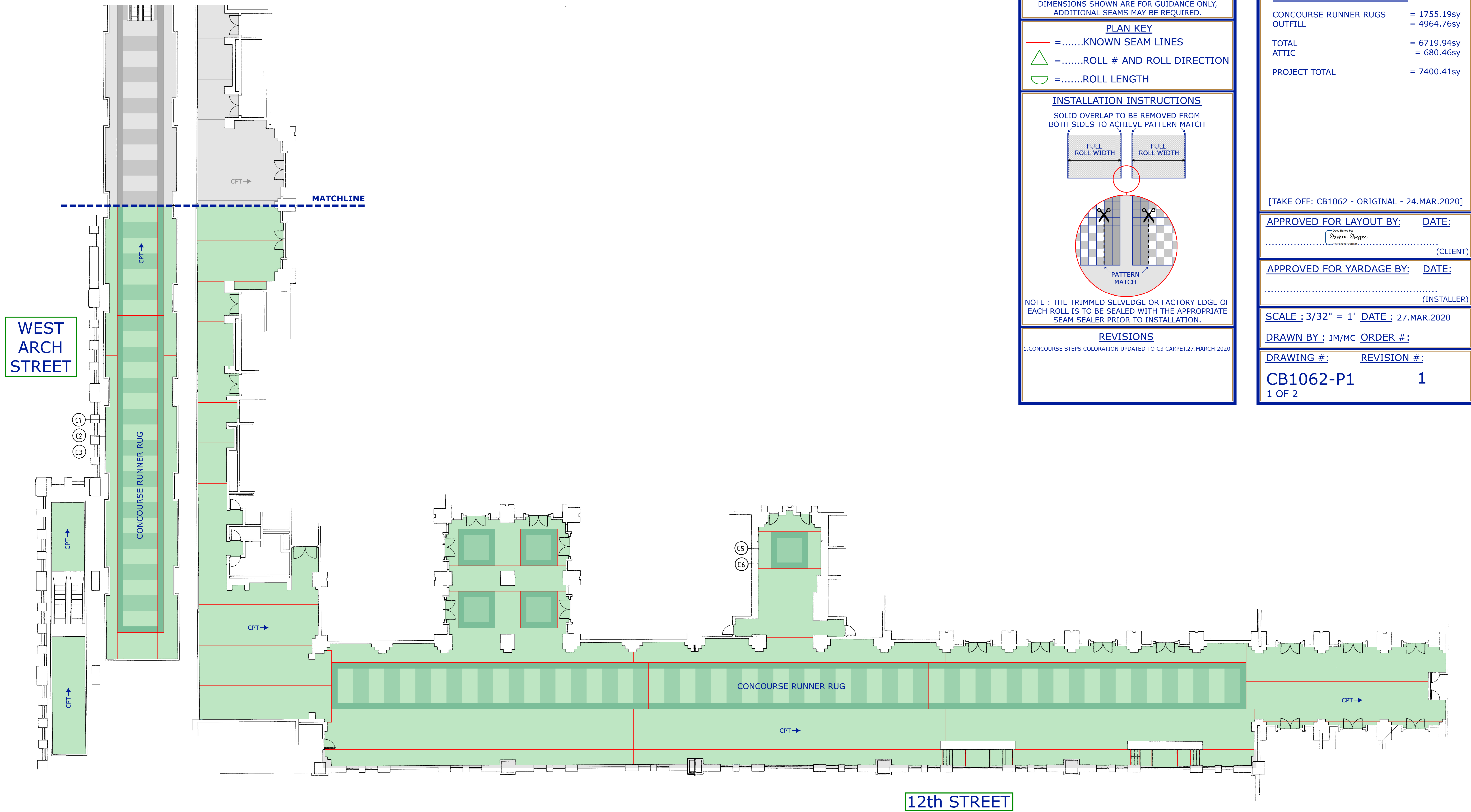

0 4' 8' 12' 24' 36' 48'

SCALE : 3/32" = 1'

12th STREET / 13th STREET / WEST ARCH STREET

13th STREET

WEST ARCH STREET

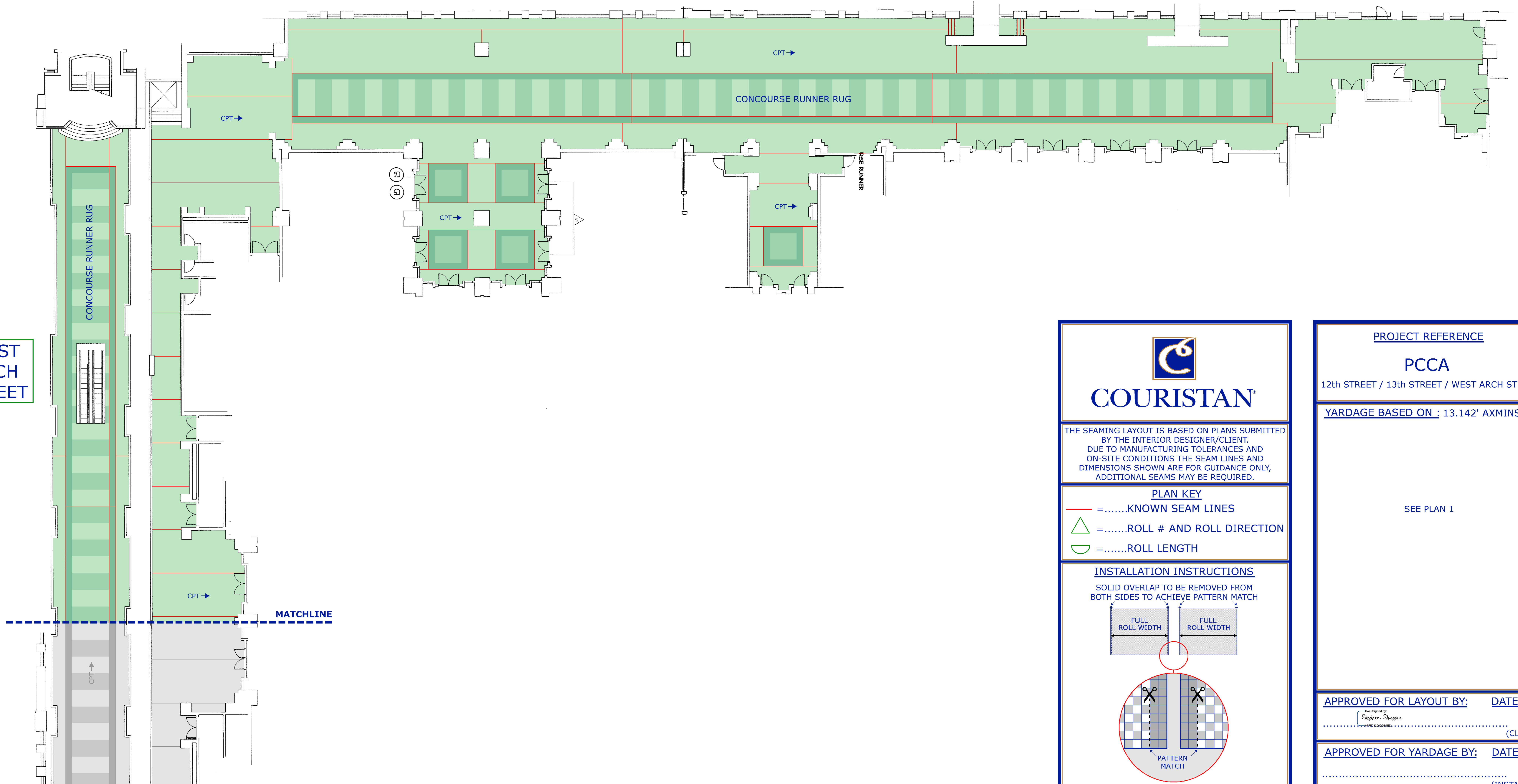

0 4' 8' 12' 24' 36' 48'

SCALE : 3/32" = 1'



COURISTAN®

THE SEAMING LAYOUT IS BASED ON PLANS SUBMITTED BY THE INTERIOR DESIGNER/CLIENT. DUE TO MANUFACTURING TOLERANCES AND ON-SITE CONDITIONS THE SEAM LINES AND DIMENSIONS SHOWN ARE FOR GUIDANCE ONLY, ADDITIONAL SEAMS MAY BE REQUIRED.

PLAN KEY

- =KNOWN SEAM LINES
- ▲ =ROLL # AND ROLL DIRECTION
- ▾ =ROLL LENGTH

INSTALLATION INSTRUCTIONS

SOLID OVERLAP TO BE REMOVED FROM BOTH SIDES TO ACHIEVE PATTERN MATCH

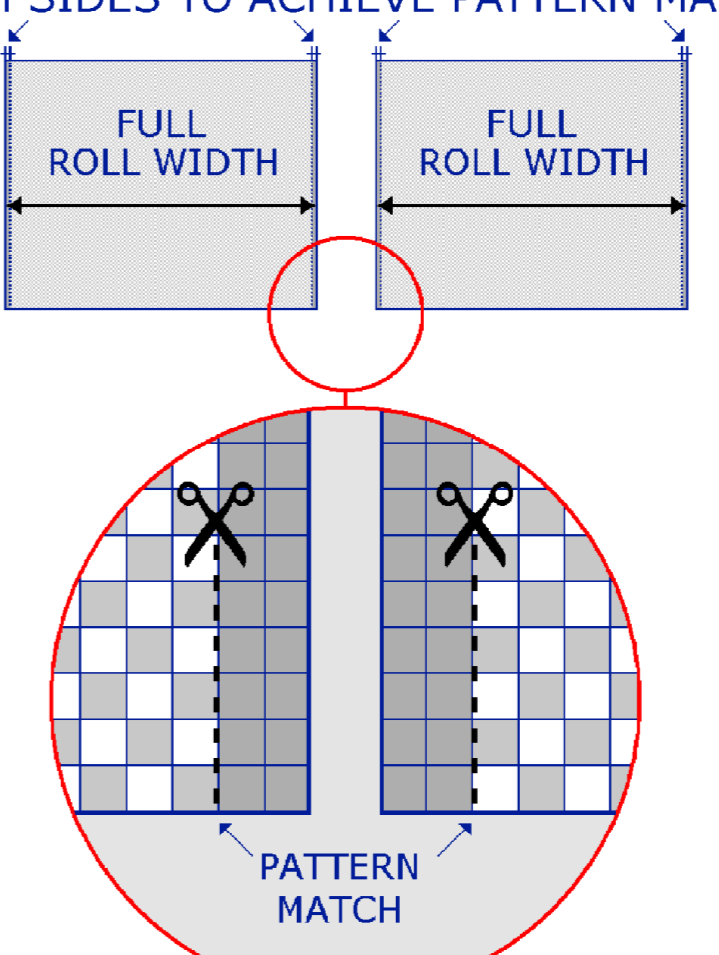

NOTE : THE TRIMMED SELVEDGE OR FACTORY EDGE OF EACH ROLL IS TO BE SEALED WITH THE APPROPRIATE SEAM SEALER PRIOR TO INSTALLATION.

REVISIONS

1. CONCOURSE STEPS COLORATION UPDATED TO C3 CARPET. 27.MARCH.2020

PROJECT REFERENCE

PCCA

12th STREET / 13th STREET / WEST ARCH STREET

YARDAGE BASED ON : 13.142' AXMINSTER

SEE PLAN 1

APPROVED FOR LAYOUT BY: _____ DATE: _____
(Signature)
 (CLIENT)

APPROVED FOR YARDAGE BY: _____ DATE: _____
 (INSTALLER)

SCALE : 3/32" = 1' DATE : 27.MAR.2020

DRAWN BY : JM/MC ORDER #:

DRAWING # : REVISION #:

CB1062-P2 **1**

2 OF 2



COURISTAN

Shipping Summary - CUK 13607 Pennsylvania Convention Center

Customer P.O. - 33744
Spec. 7 x 9 row, 0.250"ph, 2/47, 80:20 W/N

DESPATCHED

Quantity ordered	7400.00	with 0% overage allowance
Quantity shipped	7400.41	
Overage	0.01	%

Dated 16th Sep 2020

BATCH NO.	BALE NO.	WIDTH	ORDER REF.	DESIGN	LENGTH FEET	Y ²	ROLL REF	SIDEMARK REF	EX-MILL	E.T.A. PHILADELPHIA, PA BY SEA
20A-05552	187658	13.14	13607	1/43080	104	151.86	ROLL 1	12th, 13th AND WEST ARCH STREET - CORRIDORS	15-Sep-20	24-Oct-20
20A-05552	187659	13.14	13607	1/43080	104	151.86	ROLL 1	12th, 13th AND WEST ARCH STREET - CORRIDORS	15-Sep-20	24-Oct-20
20A-05552	187660	13.14	13607	1/43080	104	151.86	ROLL 1	12th, 13th AND WEST ARCH STREET - CORRIDORS	15-Sep-20	24-Oct-20
20A-05552	187661	13.14	13607	1/43080	104	151.86	ROLL 2	12th, 13th AND WEST ARCH STREET - CORRIDORS	15-Sep-20	24-Oct-20
20A-05552	187662	13.14	13607	1/43080	104	151.86	ROLL 2	12th, 13th AND WEST ARCH STREET - CORRIDORS	15-Sep-20	24-Oct-20
20A-05552	187663	13.14	13607	1/43080	104	151.86	ROLL 2	12th, 13th AND WEST ARCH STREET - CORRIDORS	15-Sep-20	24-Oct-20
20A-05552	187664	13.14	13607	1/43080	92	134.34	ROLL 3	12th, 13th AND WEST ARCH STREET - CORRIDORS	15-Sep-20	24-Oct-20
20A-05552	187665	13.14	13607	1/43080	92	134.34	ROLL 3	12th, 13th AND WEST ARCH STREET - CORRIDORS	15-Sep-20	24-Oct-20
20A-05552	187666	13.14	13607	1/43080	72	105.14	ROLL 4	12th, 13th AND WEST ARCH STREET - CORRIDORS	15-Sep-20	24-Oct-20
20A-05552	187667	13.14	13607	1/43080	104	151.86	ROLL 5	12th, 13th AND WEST ARCH STREET - CORRIDORS	15-Sep-20	24-Oct-20
20A-05552	187668	13.14	13607	1/43080	92	134.34	ROLL 6	12th, 13th AND WEST ARCH STREET - CORRIDORS	15-Sep-20	24-Oct-20
20A-05552	187669	13.14	13607	1/43081	126	183.99	ROLL 7	12th, 13th AND WEST ARCH STREET - CORRIDORS	15-Sep-20	24-Oct-20
20A-05552	187670	13.14	13607	1/10323	103	150.40	ROLL 8	12th, 13th AND WEST ARCH STREET - CORRIDORS	15-Sep-20	24-Oct-20
20A-05552	187671	13.14	13607	1/10323	103	150.40	ROLL 8	12th, 13th AND WEST ARCH STREET - CORRIDORS	15-Sep-20	24-Oct-20
20A-05552	187672	13.14	13607	1/10323	103	150.40	ROLL 8	12th, 13th AND WEST ARCH STREET - CORRIDORS	15-Sep-20	24-Oct-20
20A-05552	187673	13.14	13607	1/10323	103	150.40	ROLL 8	12th, 13th AND WEST ARCH STREET - CORRIDORS	15-Sep-20	24-Oct-20
20A-05552	187674	13.14	13607	1/10323	103	150.40	ROLL 8	12th, 13th AND WEST ARCH STREET - CORRIDORS	15-Sep-20	24-Oct-20
20A-05552	187675	13.14	13607	1/10323	103	150.40	ROLL 8	12th, 13th AND WEST ARCH STREET - CORRIDORS	15-Sep-20	24-Oct-20
20A-05552	187676	13.14	13607	1/10323	103	150.40	ROLL 8	12th, 13th AND WEST ARCH STREET - CORRIDORS	15-Sep-20	24-Oct-20
20A-05552	187677	13.14	13607	1/10323	103	150.40	ROLL 8	12th, 13th AND WEST ARCH STREET - CORRIDORS	15-Sep-20	24-Oct-20
20A-05552	187678	13.14	13607	1/10323	103	150.40	ROLL 8	12th, 13th AND WEST ARCH STREET - CORRIDORS	15-Sep-20	24-Oct-20
20A-05552	187679	13.14	13607	1/10323	103	150.40	ROLL 8	12th, 13th AND WEST ARCH STREET - CORRIDORS	15-Sep-20	24-Oct-20
20A-05552	187680	13.14	13607	1/10323	103	150.40	ROLL 8	12th, 13th AND WEST ARCH STREET - CORRIDORS	15-Sep-20	24-Oct-20
20A-05552	187681	13.14	13607	1/10323	103	150.40	ROLL 8	12th, 13th AND WEST ARCH STREET - CORRIDORS	15-Sep-20	24-Oct-20
20A-05552	187682	13.14	13607	1/10323	103	150.40	ROLL 8	12th, 13th AND WEST ARCH STREET - CORRIDORS	15-Sep-20	24-Oct-20
20A-05552	187683	13.14	13607	1/10323	103	150.40	ROLL 8	12th, 13th AND WEST ARCH STREET - CORRIDORS	15-Sep-20	24-Oct-20
20A-05552	187684	13.14	13607	1/10323	103	150.40	ROLL 8	12th, 13th AND WEST ARCH STREET - CORRIDORS	15-Sep-20	24-Oct-20
20A-05552	187685	13.14	13607	1/10323	103	150.40	ROLL 8	12th, 13th AND WEST ARCH STREET - CORRIDORS	15-Sep-20	24-Oct-20
20A-05552	187686	13.14	13607	1/10323	103	150.40	ROLL 8	12th, 13th AND WEST ARCH STREET - CORRIDORS	15-Sep-20	24-Oct-20
20A-05552	187687	13.14	13607	1/10323	103	150.40	ROLL 8	12th, 13th AND WEST ARCH STREET - CORRIDORS	15-Sep-20	24-Oct-20
20A-05552	187688	13.14	13607	1/10323	103	150.40	ROLL 8	12th, 13th AND WEST ARCH STREET - CORRIDORS	15-Sep-20	24-Oct-20
20A-05552	187689	13.14	13607	1/10323	103	150.40	ROLL 8	12th, 13th AND WEST ARCH STREET - CORRIDORS	15-Sep-20	24-Oct-20
20A-05552	187690	13.14	13607	1/10323	121	176.69	ROLL 9	12th, 13th AND WEST ARCH STREET - CORRIDORS	15-Sep-20	24-Oct-20
20A-05552	187691	13.14	13607	1/10323	114	166.47	ROLL 10	12th, 13th AND WEST ARCH STREET - CORRIDORS	15-Sep-20	24-Oct-20
20A-05552	187692	13.14	13607	1/10323	114	166.47	ROLL 10	12th, 13th AND WEST ARCH STREET - CORRIDORS	15-Sep-20	24-Oct-20
20A-05552	187693	13.14	13607	1/10323	114	166.47	ROLL 10	12th, 13th AND WEST ARCH STREET - CORRIDORS	15-Sep-20	24-Oct-20
20A-05552	187694	13.14	13607	1/10323	114	166.47	ROLL 10	12th, 13th AND WEST ARCH STREET - CORRIDORS	15-Sep-20	24-Oct-20
20A-05552	187695	13.14	13607	1/10323	55	80.31	ROLL 11	12th, 13th AND WEST ARCH STREET - CORRIDORS	15-Sep-20	24-Oct-20
20A-05552	187696	13.14	13607	1/10323	92	134.34	ROLL 12	12th, 13th AND WEST ARCH STREET - CORRIDORS	15-Sep-20	24-Oct-20

20A-05552	187697	13.14	13607	1/10323	92	134.34	ROLL 12	12th, 13th AND WEST ARCH STREET - CORRIDORS	15-Sep-20	24-Oct-20
20A-05552	187698	13.14	13607	1/10323	92	134.34	ROLL 12	12th, 13th AND WEST ARCH STREET - CORRIDORS	15-Sep-20	24-Oct-20
20A-05552	187699	13.14	13607	1/10323	92	134.34	ROLL 12	12th, 13th AND WEST ARCH STREET - CORRIDORS	15-Sep-20	24-Oct-20
20A-05552	187700	13.14	13607	1/10323	68	99.30	ROLL 13	12th, 13th AND WEST ARCH STREET - CORRIDORS	15-Sep-20	24-Oct-20
20A-05552	187701	13.14	13607	1/10323	68	99.30	ROLL 13	12th, 13th AND WEST ARCH STREET - CORRIDORS	15-Sep-20	24-Oct-20
20A-05552	187702	13.14	13607	1/10323	68	99.30	ROLL 13	12th, 13th AND WEST ARCH STREET - CORRIDORS	15-Sep-20	24-Oct-20
20A-05552	187703	13.14	13607	1/10323	68	99.30	ROLL 13	12th, 13th AND WEST ARCH STREET - CORRIDORS	15-Sep-20	24-Oct-20
20A-05552	187704	13.14	13607	1/10323	68	99.30	ROLL 13	12th, 13th AND WEST ARCH STREET - CORRIDORS	15-Sep-20	24-Oct-20
20A-05552	187705	13.14	13607	1/43080+1	124	181.07	AS1	12th, 13th AND WEST ARCH STREET - CORRIDORS	15-Sep-20	24-Oct-20
20A-05552	187706	13.14	13607	1/10323	114	166.47	AS2	12th, 13th AND WEST ARCH STREET - CORRIDORS	15-Sep-20	24-Oct-20
20A-05552	187707	13.14	13607	1/10323	114	166.47	AS2	12th, 13th AND WEST ARCH STREET - CORRIDORS	15-Sep-20	24-Oct-20
20A-05552	187708	13.14	13607	1/10323	114	166.47	AS2	12th, 13th AND WEST ARCH STREET - CORRIDORS	15-Sep-20	24-Oct-20
					5068	7400.41				